

**NYC Department of Education  
Building Condition Assessment Survey 2018-2019**

**Architectural Inspection**

**R827**

**School: P.S. 3 ANNEX GYM (CYO BLDG) - STATEN ISLAND, 6581 HYLAN BLVD, STATEN ISLAND, NY, 10309**

InspectionId	Inspection Type	Time In	Last Edited
3298	ARCHITECTURAL - SENIOR	2019-03-26 06:40AM	2019-04-01 08:24AM
3302	ARCHITECTURAL - ASSOCIATE	2019-03-26 11:12AM	2019-06-11 01:43PM

**Asset Data**

Question	Answer
Was the Building Fully Accessible for Inspection?	No
Comments on Inaccessible Inspection	The Roof was not accessible.
Principal(s) Information	
Principal Name	James McKeon
Principal Organization	R025 SPED - Staten Island
Meeting with Principal?	Yes
Principal Feedback	The Principal had no comments regarding the buildings physical condition at this time .
Custodian	Was not present
Fireman	Jackie Kitzen (Housekeeping)
Building Square Footage	14,000
Comments on the Area (Square Feet)	N/A
Comments on the Stories (Floors) plus Basements	1(No Basement )
Comments on the Year Built	2001
Comments on the Student Population	216
Comments on the Staff Population	3
Comments on the Number of Classrooms	None
Weather	Fair
Facade Photo	



Hylan Boulevard - South view

Main Entrance Photo



Facade A - Hylan Boulevard

**NYC Department of Education  
Building Condition Assessment Survey 2018-2019**

**Architectural Inspection**

**R827**

Roof Photo



Have any Systems/Major Building Components been upgraded?  
 Have there been any New Building Additions?  
 Tandem  
 Leased Space?  
     Year Leased  
     Inspection Type

Roof 1 - East view  
 No System Upgraded  
 No New Construction  
 No Tandem  
 Yes  
 2012  
 Partial Inspection

**Priority Condition**

Exist Last Year?	Priority Category	Condition Description	Component Affected	Location Description	Person(s) Notified	Person(s) Title	Photo Image
No	Other	A section of bleacher seating on the West side of the Gymnasium poses a potential hazard.	Other (PBS Related)	West Side of Gymnasium	Fran Rosito	N/a	

**Structural Engineer Required**

Structural Condition Type	Condition Description	Component Affected	Location Description	Person(s) Notified	Person(s) Title	Photo Image
No condition recorded						

**Accessibility**

Accessibility Status Question	Response			
	Exists	Complies	Required	Deficiency
<b>Physical Breakdown Structure</b>				
<b>FUNCTIONAL ACCESSIBILITY</b>				
<b>Exterior Routes</b>				
Exterior Entrances & Exits		Yes		
Exterior H/C Lifts	No		No	
Exterior Ramps and Railings	Yes		No	
<b>Interior Routes</b>				
Corridor and Lobby H/C Lifts	No		No	
Interior Corridor Doors And Hardware	Yes		No	
Interior Corridors & Lobbies		Yes		
Interior Elevators	No			
Interior Lobby Doors And Hardware		Yes		
Interior Ramps	No			
<b>Rooms &amp; Spaces</b>				
Art Rooms	No			
Auditorium	No			

**NYC Department of Education  
Building Condition Assessment Survey 2018-2019**

**Architectural Inspection**

**R827**

Physical Breakdown Structure	Exists	Complies	Required	Deficiency
Cafeteria	No			
Classrooms	No			
Computer Rooms	No			
Gymnasium				
1st Floor	Yes	Yes		
Library	No			
Main Office	No			
Multi-purpose Room	No			
Nurse's Office	No			
Pool	No			
Science Lab	No			
Toilet Rooms (boys)				
1st Floor	Yes	Yes		
Toilet Rooms (girls)				
1st Floor	Yes	Yes		
Toilet Rooms (staff)				
1st Floor	Yes	Yes		

**Building Template**

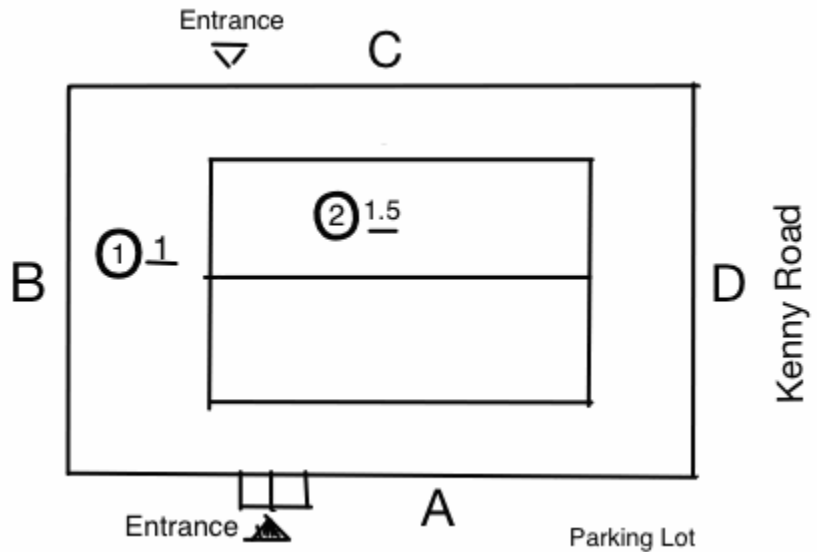

**Inspection**

Question	Response
<b>Architectural</b>	
<b>ATHLETIC FIELDS</b>	Does not exist
<b>EXTERIOR</b>	Inspected
<b>AREAWAY</b>	Does not exist
<b>AWNINGS AND CANOPIES</b>	Inspected
Condition	2- Between Good and Fair
Deficiency	No deficiencies recorded
<b>CHIMNEY</b>	Does not exist
<b>COPING</b>	Inaccessible
<b>CORNICE</b>	Does not exist
<b>DOORS</b>	Inspected
<b>DOOR HARDWARE</b>	Inspected
Condition	2- Between Good and Fair

**NYC Department of Education  
Building Condition Assessment Survey 2018-2019**

*Architectural Inspection*

**R827**

<b>Question</b>	<b>Response</b>
<b>EXTERIOR</b>	
<b>DOORS</b>	
<b>DOOR HARDWARE</b>	
Deficiency	No deficiencies recorded
<b>DOORS AND FRAMES</b>	Inspected
Condition	2- Between Good and Fair
Deficiency	No deficiencies recorded
<b>LINTELS</b>	Inspected
Condition	2- Between Good and Fair
Deficiency	No deficiencies recorded
<b>TRANSOM/SIDE LIGHT</b>	Inspected
Condition	2- Between Good and Fair
Deficiency	No deficiencies recorded
<b>EXTERIOR SOFFITS</b>	Does not exist
<b>EXTERIOR WALLS</b>	Inspected
Material Type(s)	Masonry
Replacement Quantity	20,000
Replacement Uom	S.F.
Instance on All Facades	Inspected
Instance Condition	2- Between Good and Fair
Instance Quantity	20,000
Instance Quantity Uom	S.F.
Deficiency	No deficiencies recorded
<b>LOADING DOCK</b>	Does not exist
<b>LOUVER</b>	Does not exist
<b>PARAPETS</b>	Inaccessible
<b>PLAZA DECK</b>	Does not exist
<b>ROOF</b>	Inaccessible
<b>STAIRS/RAMPS: EXTERIOR</b>	Does not exist
<b>WINDOWS</b>	Inspected
Replacement Quantity	8,000
Replacement Uom	S.F.
<b>EXTERIOR GUARDS</b>	Does not exist
<b>LINTELS</b>	Inspected
Condition	2- Between Good and Fair
Deficiency	No deficiencies recorded
<b>WINDOWS</b>	Inspected
Material Type(s)	Aluminum
Instance on Aluminum - Double Hung:All Facades	Inspected
Instance Condition	2- Between Good and Fair
Instance Quantity	8,000
Instance Quantity Uom	S.F.
Installation Year	2001
Source of Installation Year	Inspector Estimate
Deficiency	No deficiencies recorded
<b>INTERIOR</b>	Inspected
<b>AUDITORIUM</b>	Does not exist
<b>CAFETERIA</b>	Does not exist
<b>CLASSROOMS/CORRIDORS/ADMIN SPACES</b>	Does not exist
<b>GYMNASIUM</b>	
Instance on 1st Floor	Inspected
<b>Ceiling</b>	
Instance on 1st Floor	Does not exist
<b>Door(s)</b>	

**NYC Department of Education  
Building Condition Assessment Survey 2018-2019**

*Architectural Inspection*

**R827**

Question	Response
<b>INTERIOR</b>	
<b>GYMNASIUM</b>	
<b>Door(s)</b>	
Instance on 1st Floor	Inspected
Instance Condition	2- Between Good and Fair
Deficiency	No deficiencies recorded
<b>Fixed Equipment</b>	
Instance on 1st Floor	Inspected
Instance Condition	2- Between Good and Fair
Deficiency	No deficiencies recorded
<b>Floor Finish</b>	
Instance on 1st Floor	Inspected
Instance Condition	2- Between Good and Fair
Deficiency	No deficiencies recorded
<b>Seating</b>	
Instance on 1st Floor	Inspected
Instance Condition	2- Between Good and Fair
Deficiency	DAMAGED BLEACHERS
Deficiency Location/Instance	West, North, East of Room
Deficiency Quantity	8
Quantity Uom	S.F.
Potential Action	REPLACE
Urgency of Action	PRIORITY 3
Purpose of Action	LEVEL 2
Violations	No violations recorded
Deficiency	DAMAGED BLEACHERS
Deficiency Location/Instance	West side of room.
Deficiency Quantity	4
Quantity Uom	S.F.
Potential Action	REPLACE
Urgency of Action	PRIORITY 5
Purpose of Action	LEVEL 6
Deficiency Photo 1	
Violations	West side of room
Violations	No violations recorded
<b>Sliding-folding Partition</b>	
Instance on 1st Floor	Does not exist
<b>Stage</b>	
Instance on 1st Floor	Does not exist
<b>Walls</b>	
Instance on 1st Floor	Inspected
Instance Condition	2- Between Good and Fair
Deficiency	MASONRY:CRACKS/SPALLING
Deficiency Location/Instance	West, South of Room
Deficiency Quantity	30
Quantity Uom	S.F.
Potential Action	REPLACE
Urgency of Action	PRIORITY 3

**NYC Department of Education  
Building Condition Assessment Survey 2018-2019**

*Architectural Inspection*

**R827**

Question	Response
<b>INTERIOR</b>	
<b>GYMNASIUM</b>	
<b>Walls</b>	
Purpose of Action	LEVEL 2
Deficiency Photo 1	
Violations	West of Room
Deficiency	No violations recorded
Deficiency Location/Instance	WALL PADDING:DETERIORATED
Deficiency Quantity	West of Room
Quantity Uom	20
Potential Action	S.F.
Urgency of Action	REPLACE
Purpose of Action	PRIORITY 3
Deficiency Photo 1	LEVEL 2
	
Violations	West of Room
	No violations recorded
<b>Window Curtains/Shades/Blinds</b>	
Instance on 1st Floor	Does not exist
<b>INTERIOR DOOR HARDWARE</b>	
Condition	Inspected
Deficiency	2- Between Good and Fair
	No deficiencies recorded
<b>INTERIOR GUARDS</b>	
	Does not exist
<b>KITCHEN</b>	
	Does not exist
<b>LIBRARY</b>	
	Does not exist
<b>LOCKER ROOM</b>	
	Does not exist
<b>MULTI-PURPOSE ROOM</b>	
	Does not exist
<b>POOLS</b>	
	Does not exist
<b>SCIENCE DEMO ROOM</b>	
	Does not exist
<b>SCIENCE LAB</b>	
	Does not exist
<b>SCIENCE PREP ROOM</b>	
	Does not exist
<b>SHOWER ROOM</b>	
	Does not exist
<b>STAIRS/RAMPS: INTERIOR</b>	
	Does not exist
<b>STRUCTURAL</b>	
	Inspected
<b>COLUMNS/BEAMS/BEARING WALLS</b>	
	Inspected
Condition	2- Between Good and Fair
Deficiency	No deficiencies recorded
<b>FLOOR STRUCTURE</b>	
	Inspected
Condition	2- Between Good and Fair
Deficiency	No deficiencies recorded

**NYC Department of Education  
Building Condition Assessment Survey 2018-2019**

*Architectural Inspection*

**R827**

<b>Question</b>	<b>Response</b>
<b>INTERIOR</b>	
<b>STRUCTURAL</b>	
<b>FOUNDATION WALLS</b>	Inspected
Material Type(s)	Concrete
Condition	2- Between Good and Fair
Deficiency	No deficiencies recorded
<b>ROOF STRUCTURE</b>	Inspected
Condition	2- Between Good and Fair
Deficiency	No deficiencies recorded
<b>VAULTS-BUNKERS</b>	Does not exist
<b>TOILET ROOMS - STAFF</b>	Does not exist
<b>TOILET ROOMS - STUDENTS</b>	Does not exist
<b>LIFE SAFETY</b>	Inspected
<b>F.D. HOLDING AREA</b>	Does not exist
<b>STEEL STAIRS</b>	Does not exist
<b>SITE</b>	Does not exist