

**NYC Department of Education
Building Condition Assessment Survey 2017 - 2018**

Architectural Inspection

X945

Asset: P.S. 87 TRANSPORTABLE - X, 1935 BUSSING AVENUE, New York, 10466

Inspection Id	Inspection Type	Time In	Last Edited
	Architectural - Senior	2018-05-25 7:26 AM	2018-06-01 11:43 AM
	Architectural - Associate	2018-05-25 7:25 AM	2018-05-25 5:17 PM

Asset Data

Question	Answer
Was the building fully accessible for inspection	Yes
Principal(s) Information	
Principal Name	Donna Anaman
Organization	P.S. 87 Transportable - Bronx
Did you meet with this Principal?	Yes
Did this Principal provide feedback?	Yes
Summary of Principal's Feedback	The Principal's comment is as follows: The Temporary Classroom Units are in overall poor condition and should be removed.
Custodian	Was not present
Fireman	Leroy Harris (Handyman)
Building Square Footage	5200
Comments on the Area	None
Comments on the Stories (Floors) plus Basements	1 (No Basement)
Comments on the Number of Classrooms	8
Comments on the Year Built	1998
Student Population	185
Staff Population	14
Weather	Fair
Facade Photo	



Facade A - Northwest view

**NYC Department of Education
Building Condition Assessment Survey 2017 - 2018**

Architectural Inspection

X945

Main Entrance Photo

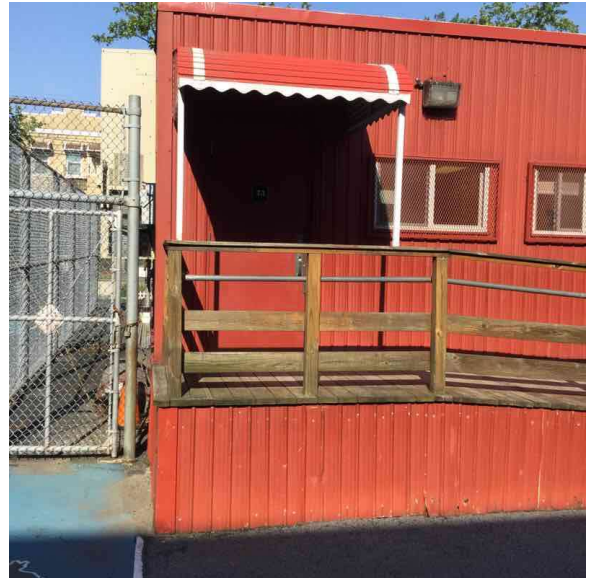

Facade A - Unit T1

Roof Photo



Roofs 1-4 - Northwest view

Have any Systems/Major Building Components been upgraded?

Yes

Systems: Partial Roofing repairs, Exterior Door repairs, Interior Classroom rehab (70%)

Year: 2015

Systems: Roofing repairs

Year: 2012

Systems: Partial Stair, Ramp, Exterior Metal Wall Panel and Toilet Room repairs

Year: 2010

Have there been any New Building Additions?

No

Tandem Schools?

No

Leased Space?

No

Priority Condition

Priority Condition Exist Last Year?	Priority Category	Condition Description	Component Affected	Location Description	Person(s) Notified	Person(s) Title	PhotoImage
-------------------------------------	-------------------	-----------------------	--------------------	----------------------	--------------------	-----------------	------------

No condition recorded

Structural Engineer Required

NYC Department of Education
Building Condition Assessment Survey 2017 - 2018

Architectural Inspection

X945

Structural Condition Type	Condition Description	Component Affected	Location Description	Person(s) Notified	Person(s) Title	PhotoImage
No condition recorded						

Accessibility

Accessibility Status Question	Response
Is the primary or secondary entrance on an accessible route?	Yes
Is the building a multi-story building?	No
Do any of the following spaces exist? Classroom, Art Room, Auditorium, Cafeteria, Computer, Gymnasiums, Library, Multipurpose Room, Science Labs	Yes
For the spaces that do exist, are they ALL accessible?	Yes
Is there at least one Boys and Girls or Unisex toilet accessible in the building	Yes

Physical Breakdown Structure	Exists	Complies	Required	Deficiency
------------------------------	--------	----------	----------	------------

FUNCTIONAL ACCESSIBILITY

Exterior Routes

Exterior Entrances & Exits		Yes		
Exterior H/C Lifts	No		No	
Exterior Ramps and Railings	Yes	Yes		

Interior Routes

Corridor and Lobby H/C Lifts	No		No	
Interior Corridor Doors and Hardware	Yes	Yes		
Interior Corridors and Lobbies		Yes		
Interior Elevators	No			
Interior Lobby Doors and Hardware		Yes		
Interior Ramps	No			

Rooms & Spaces

Art Rooms		No		
Auditorium		No		
Cafeteria		No		
Classrooms	1st Floor - Rooms T1-T8		Yes	
Computer Rooms		No		
Gymnasium		No		
Library		No		
Main Office		No		
Multi-purpose Room		No		
Nurse's Room		No		
Pool		No		
Science Lab		No		
Toilet Rooms (Boys)	Unisex in each Classroom		Yes	
Toilet Rooms (Girls)	Unisex in each Classroom		Yes	
Toilet Rooms (Staff)		No		

NYC Department of Education
 Building Condition Assessment Survey 2017 - 2018

Architectural Inspection

X945

Building Template

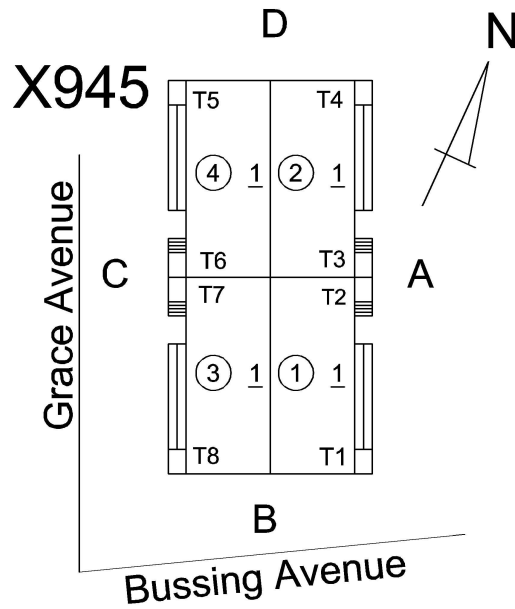

Inspection

Question	Response
Architectural	
EXTERIOR	Inspected
AWNINGS AND CANOPIES	Inspected
Condition	2 - Between Good and Fair
Deficiency	No deficiencies recorded
DOORS	Inspected
DOORS AND FRAMES	Inspected
Condition	2 - Between Good and Fair
Deficiency	No deficiencies recorded
DOOR HARDWARE	Inspected
Condition	3 - Fair
Deficiency	No deficiencies recorded
EXTERIOR WALLS	Inspected
Material Type(s)	Steel
Replacement Quantity	8,000
Replacement Uom	S.F.
Instance on All Facades	Inspected
Instance Condition	3 - Fair
Instance Quantity	8,000
Instance Quantity Uom	S.F.
Deficiency	METAL PANEL: SEVERE DENTS

**NYC Department of Education
Building Condition Assessment Survey 2017 - 2018**

Architectural Inspection

X945

Question	Response
EXTERIOR	
EXTERIOR WALLS	
Roof Plan reference	
Elevation	
Deficiency Quantity	100
Quantity Uom	S.F.
Potential Action	REPLACE
Urgency of Action	PRIORITY 4
Purpose of Action	LEVEL 2
Deficiency Photo1	
Violations	Facade A No violations recorded.
EXTERIOR SOFFITS	Does not Exist
LOUVER	Inspected
Condition	2 - Between Good and Fair
Deficiency	No deficiencies recorded
ROOF	Inspected
Roofing	Inspected
Replacement Quantity	5,200
Replacement Uom	S.F.
LEADERS, GUTTERS, DOWNSPOUTS, SCUPPERS	Does not Exist
ROOFING	Inspected
Instance on Single Ply, Fully Adhered Roof: All Roofs	Inspected
Instance Condition	3 - Fair
Instance Quantity	5,200

**NYC Department of Education
Building Condition Assessment Survey 2017 - 2018**

Architectural Inspection

X945

Question	Response
EXTERIOR	
ROOF	
Roofing	
ROOFING	
Instance Quantity Uom	S.F.
Does the roof have major mechanical equipment sitting on Dunnage Steel less than 18" above the Roofing?	No
Installation Year	1998
Source of Installation	Documented
Deficiency	No deficiencies recorded
STAIRS/RAMPS: EXTERIOR	Inspected
RAILINGS	Inspected
Condition	2 - Between Good and Fair
Deficiency	No deficiencies recorded
STAIRS/RAMPS	Inspected
Condition	2 - Between Good and Fair
Deficiency	No deficiencies recorded
WINDOWS	Inspected
Replacement Quantity	256
Replacement Uom	S.F.
EXTERIOR GUARDS	Inspected
Condition	2 - Between Good and Fair
Deficiency	No deficiencies recorded
WINDOWS	Inspected
Material Type(s)	Aluminum
Instance on Aluminum - Other: Facade A and C	Inspected
Instance Condition	3 - Fair
Instance Quantity	256
Instance Quantity Uom	S.F.
Installation Year	1998
Source of Installation	Custodial Staff
Deficiency	No deficiencies recorded
INTERIOR	Inspected
STRUCTURAL	Inspected
COLUMNS/BEAMS/BEARING WALLS	Inspected
Condition	2 - Between Good and Fair
Deficiency	No deficiencies recorded
FLOOR STRUCTURE	Inspected
Condition	2 - Between Good and Fair
Deficiency	No deficiencies recorded
ROOF STRUCTURE	Inspected
Condition	2 - Between Good and Fair
Deficiency	No deficiencies recorded
CAFETERIA	Does not Exist
CLASSROOMS/CORRIDORS/ADMIN SPACES	Inspected
Ceiling	Inspected
Condition	2 - Between Good and Fair
Deficiency	No deficiencies recorded
Door(s)	Inspected
Condition	2 - Between Good and Fair

**NYC Department of Education
Building Condition Assessment Survey 2017 - 2018**

Architectural Inspection

X945

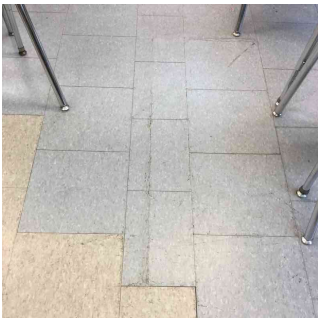
Question	Response
INTERIOR	
CLASSROOMS/CORRIDORS/ADMIN SPACES	
Door(s)	Inspected
Deficiency	No deficiencies recorded
Floor Finish	Inspected
Condition	3 - Fair
Deficiency	VINYL TILES: DETERIORATED SUBSTRATE
Deficiency Location/Instance	In T1,2,5,7,8, and others
Deficiency Quantity	250
Quantity Uom	S.F.
Potential Action	REPLACE
Urgency of Action	PRIORITY 3
Purpose of Action	LEVEL 2
Deficiency Photo1	
Violations	In T2 No violations recorded.
Walls	Inspected
Condition	2 - Between Good and Fair
Deficiency	No deficiencies recorded
INTERIOR DOOR HARDWARE	
Condition	3 - Fair
Deficiency	No deficiencies recorded
KITCHEN	
	Does not Exist
MULTI-PURPOSE ROOM	
	Does not Exist
TOILET ROOMS - STAFF	
	Does not Exist
TOILET ROOMS - STUDENTS	
	Inspected
Ceiling	Inspected
Condition	2 - Between Good and Fair
Deficiency	No deficiencies recorded
Door(s)	Inspected
Condition	2 - Between Good and Fair
Deficiency	No deficiencies recorded
Floor Finish	Inspected
Condition	2 - Between Good and Fair
Deficiency	VINYL TILES: DETERIORATED SUBSTRATE
Deficiency Location/Instance	Toilet inside T4,8
Deficiency Quantity	10
Quantity Uom	S.F.
Potential Action	REPLACE
Urgency of Action	PRIORITY 3
Purpose of Action	LEVEL 2

